

**GOODE ST**

**PRINCE ST**

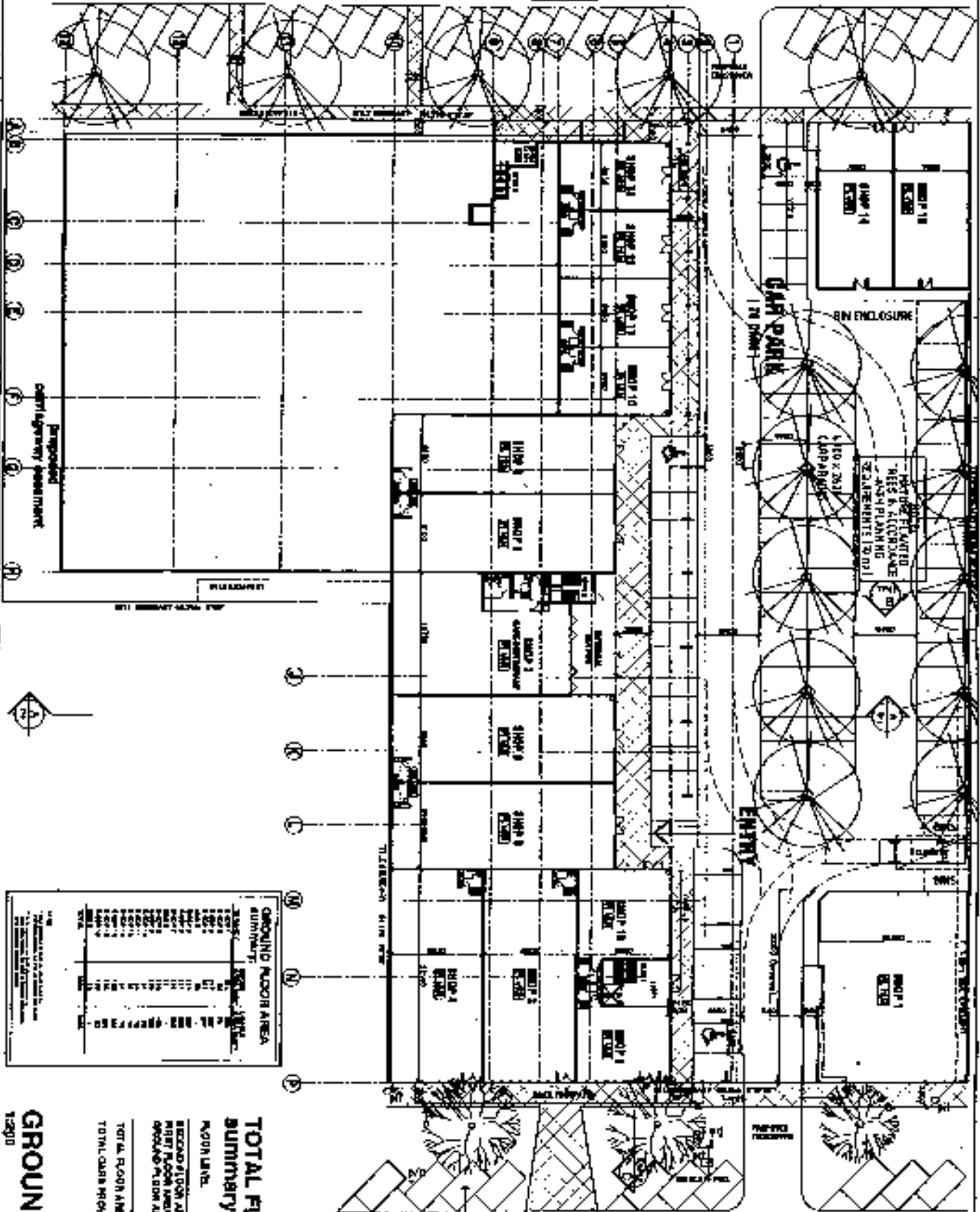

**NOTE**  
 MOST PLANTED  
 STREET TREES TO  
 BE REMOVED  
 FOR THIS PROJECT  
 EXCEPT THOSE  
 IDENTIFIED BY OWNER

**GROUND FLOOR AREA SUMMARY**

| AREA          | AREA (SQ. FT.) | PERCENT |
|---------------|----------------|---------|
| SHOP 1        | 1,100          | 1.1     |
| SHOP 2        | 1,100          | 1.1     |
| SHOP 3        | 1,100          | 1.1     |
| SHOP 4        | 1,100          | 1.1     |
| SHOP 5        | 1,100          | 1.1     |
| SHOP 6        | 1,100          | 1.1     |
| SHOP 7        | 1,100          | 1.1     |
| SHOP 8        | 1,100          | 1.1     |
| SHOP 9        | 1,100          | 1.1     |
| SHOP 10       | 1,100          | 1.1     |
| SHOP 11       | 1,100          | 1.1     |
| SHOP 12       | 1,100          | 1.1     |
| SHOP 13       | 1,100          | 1.1     |
| SHOP 14       | 1,100          | 1.1     |
| SHOP 15       | 1,100          | 1.1     |
| SHOP 16       | 1,100          | 1.1     |
| SHOP 17       | 1,100          | 1.1     |
| SHOP 18       | 1,100          | 1.1     |
| GARAGE        | 1,100          | 1.1     |
| ENTRY         | 1,100          | 1.1     |
| RIN ENCLOSURE | 1,100          | 1.1     |
| PLANTING      | 1,100          | 1.1     |
| TOTAL         | 12,800         | 100.0   |

**TOTAL FLOOR AREA SUMMARY:**

| FLOOR LEVEL                       | AREA (SQ. FT.) | TOTAL  |
|-----------------------------------|----------------|--------|
| GROUND FLOOR AREA                 | 12,800         | 12,800 |
| SECOND FLOOR AREA                 | 12,800         | 25,600 |
| THIRD FLOOR AREA                  | 12,800         | 38,400 |
| FOURTH FLOOR AREA                 | 12,800         | 51,200 |
| TOTAL GARS PROVIDED ON SITE - 170 |                |        |

**GROUND FLOOR PLAN**

12800  
 R.O.T. DATE: 11.20.03

**LEGEND**  
 FLOOR PLAN ZONE  
 12800 (PARKING)



PROPOSED OFFICE BUILDING  
 12-14 GOODE STREET  
 KENSINGTON P.O.

| NO. | REVISION | DATE     |
|-----|----------|----------|
| 1   | REVISED  | 11/20/03 |



**WILSON JONES ARCHITECTS LTD**  
 ARCHITECTS  
 12800  
 040718 11 797  
 090718

18/8/03